

\\gserver1\pub\ic\Montgomery County\01 Roads and Bridges\Bridges\083 - Butler Pike over Prophecy Creek\Des\ign\MPT\09-MPT01.dgn
 8/10/2018

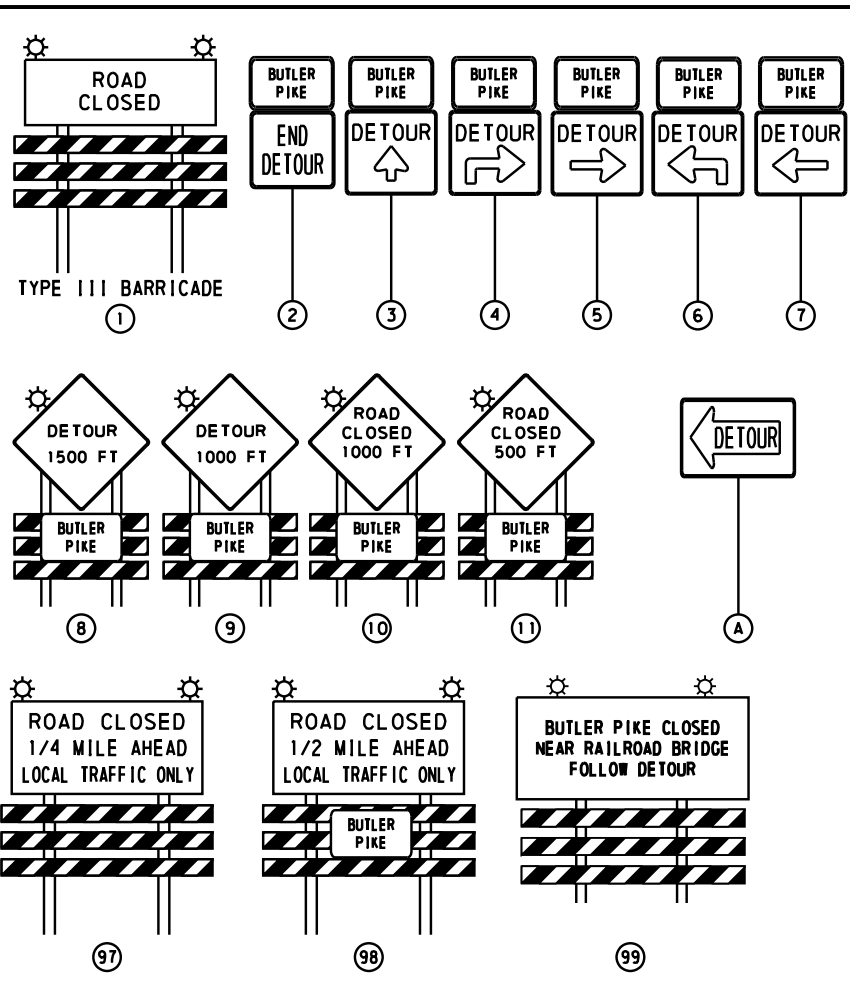
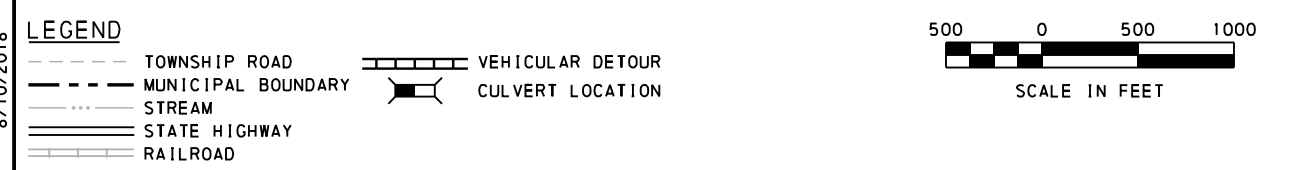
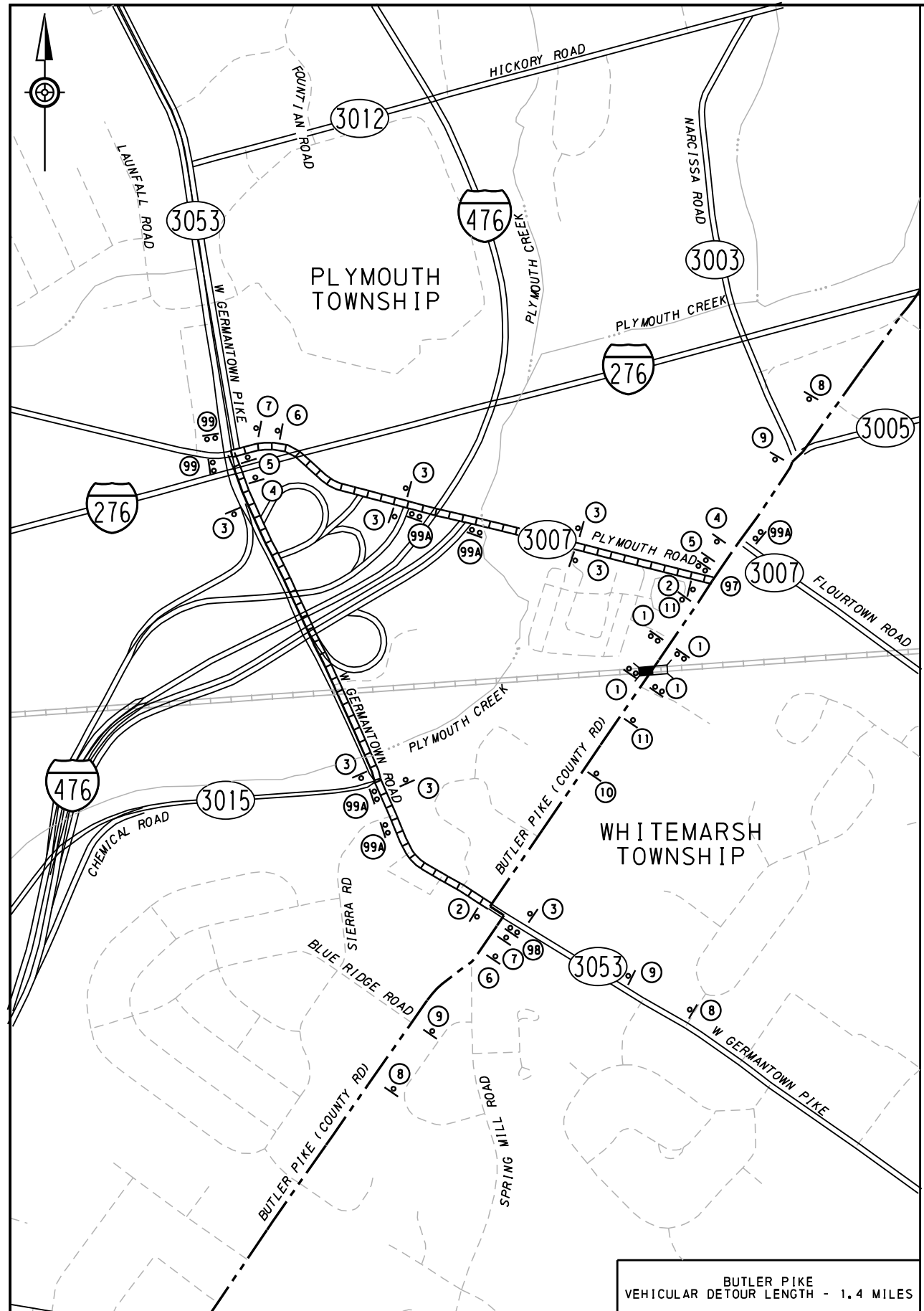

THIS WORK CONSISTS OF THE MAINTENANCE OF TRAFFIC AND THE PROTECTION OF THE TRAVELING PUBLIC APPROACHING THE CONSTRUCTION AREA AND WITHIN THE LIMITS OF CONSTRUCTION.

THE DETOUR WILL BE REQUIRED FOR THE ENTIRE DURATION OF THE CULVERT RECONSTRUCTION PROJECT.

FURNISH, ERECT, PLACE AND MAINTAIN TRAFFIC CONTROL SIGNS AND DEVICES AND MAINTAIN TRAFFIC DURING HOURS OF CONSTRUCTION AND AT ALL OTHER TIMES IN ACCORDANCE WITH THIS PLAN AND THE LATEST EDITION OF THESE PUBLICATIONS:

1. THE SPECIAL PROVISIONS OF THE CONTRACT
2. PENNDOT PUB. 212, OFFICIAL TRAFFIC CONTROL DEVICES (SUBCHAPTER E), LATEST EDITION
3. PENNDOT PUB. 111, TRAFFIC CONTROL-PAVEMENT MARKING AND SIGNING STANDARDS, LATEST EDITION
4. PENNDOT PUB. 213, TEMPORARY TRAFFIC CONTROL GUIDELINES, LATEST EDITION
5. PENNDOT PUB. 35, APPROVED CONSTRUCTION MATERIALS (BULLETIN 15), LATEST EDITION
6. PENNDOT PUB. 408, SPECIFICATIONS, LATEST EDITION
7. PENNDOT PUB. 46, TRAFFIC ENGINEERING MANUAL, LATEST EDITION
8. PENNDOT PUB. 236, HANDBOOK OF APPROVED SIGNS, LATEST EDITION
9. MANUAL ON UNIFORM TRAFFIC CONTROL DEVICES (MUTCD)

MAINTAIN ACCESS TO ALL DRIVEWAYS (COMMERCIAL AND RESIDENTIAL) AT ALL TIMES THROUGHOUT THE DURATION OF THE PROJECT.

ALL DISTANCES MAY BE ADJUSTED TO MEET FIELD CONDITIONS. THE ADJUSTMENTS ARE TO BE REVIEWED WITH THE MONTGOMERY COUNTY BRIDGE ENGINEER PRIOR TO THE RELOCATION OF THE SIGNS OR BARRICADES.

ALL TRAFFIC CONTROL DEVICES ARE TO BE INSTALLED AND INSPECTED BY THE MONTGOMERY COUNTY BRIDGE ENGINEER PRIOR TO THE START OF CONSTRUCTION.

COORDINATE WITH EXISTING OR PROPOSED PROJECTS FOR SIGN PLACEMENT ON DETOUR ROUTES.

ALL SIGNS ARE TO BE REFLECTORIZED OR ILLUMINATED DURING HOURS OF DARKNESS.

SIGN PLACEMENT AND CONDITION SHOULD BE EVALUATED AND CORRECTED AFTER EVERY STORM EVENT, IN THE EVENT OF KNOCKDOWN.

COVER OR REMOVE ALL SIGNS NOT IN USE OR IN CONFLICT WITH THE PROPOSED TRAFFIC CONTROL PLAN.

IMMEDIATELY UPON COMPLETION OF THE WORK, REMOVE ALL TRAFFIC CONTROL DEVICES. THE DEPARTMENT WILL REMOVE ANY TRAFFIC CONTROL DEVICES ERECTED BY DEPARTMENT FORCES.

DISTRICT	COUNTY	ROUTE	SECTION	SHEET
6-0	MONTGOMERY	7046		1 OF 1
PLYMOUTH AND WHITEMARSH TOWNSHIPS				
REVISION NUMBER	REVISIONS	DATE	BY	

SIGN TABULATION
INCLUDED IN ITEM NO. 0901-0001

SIGN GROUP NUMBER	SERIES	QUANTITY	SIZE	MESSAGE
1	R11-2	4	48"x30"	ROAD CLOSED
2	M4-8A	2	24"x18"	END DETOUR
3	M4-9S	8	30"x24"	BUTLER PIKE
4	M4-9SR	2	30"x24"	DETOUR, STRAIGHT
5	M4-9R	2	30"x24"	DETOUR, RIGHT
6	M4-9SL	2	30"x24"	DETOUR, LEFT
7	M4-9L	2	30"x24"	DETOUR, LEFT
8	W20-2/W30-1-3	3	36"x36"	ADVANCE DETOUR, 1500 FT.
9	W20-2/W30-1-2	3	36"x36"	ADVANCE DETOUR, 1000 FT.
10	W20-3/W30-1-2	1	36"x36"	ROAD CLOSED, 1000 FT.
11	W20-3/W30-1-1	2	36"x36"	ROAD CLOSED, 500 FT.
97	R11-3A/SPECIAL 1	1	60"x30"	ROAD CLOSED, 1/4 MILE AHEAD, LOCAL TRAFFIC ONLY
98	R11-3A/W30-1-4	1	60"x30"	ROAD CLOSED, 1/2 MILE AHEAD, LOCAL TRAFFIC ONLY
99	W23-101	7	96"x48"	BUTLER PIKE CLOSED NEAR RAILROAD BRIDGE FOLLOW DETOUR
A	M4-10L	5	48"x18"	DETOUR ARROW LEFT

MINIMUM MATERIAL REQUIRED
(FOR INFORMATION ONLY)

DESCRIPTION	QUANTITY	UNITS
POST MOUNTED SIGNS	591	S.F.
TYPE B LIGHTS	35	EACH
TYPE III BARRICADES	13	EACH

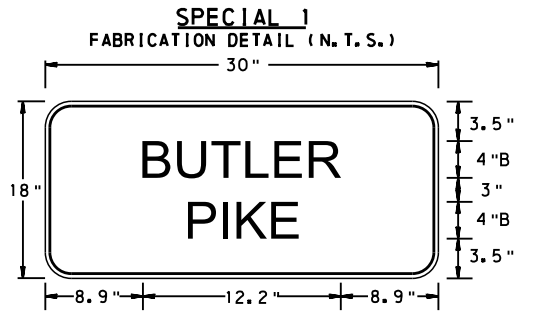

BACKGROUND - ORANGE (REFLECTIVE)
LEGEND - BLACK (NON-REFLECTIVE)

4" CAP B SERIES	4" CAP B SERIES
B - 8.90	P - 11.75
UC - 2.3	I - 1.3
T - 2.3	K - 1.1
L - 1.7	E - 2.2
LE - 1.7	E - 1.9
R - 1.9	L - 11.75
RE - 2.3	L = 30.0
L = 8.90	
L = 30.0	

RECOMMENDED: _____
ADE - TRANSPORTATION OPERATIONS

PREPARED BY:
MCCORMICK TAYLOR

PROJECT MANAGER _____
DATE _____

TRAFFIC CONTROL PLAN